

Contact type:

R = snap action
L = slow action

Other rollers available. See on page 106

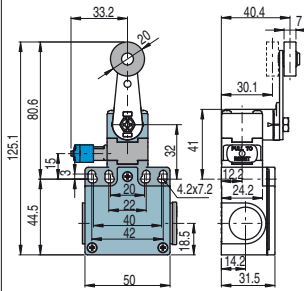

Other rollers available. See on page 106

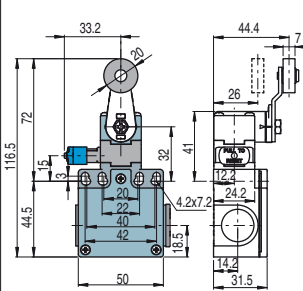

Other rollers available. See on page 106

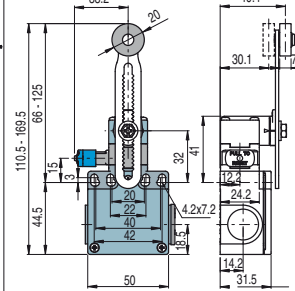

Other rollers available. See on page 106

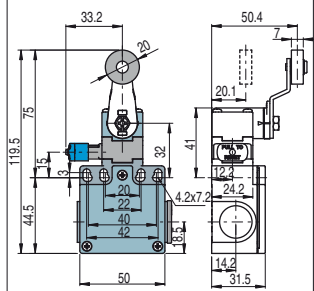

Contact blocks

6	L	FZ 652-W3M2	⊕	1NO+1NC	FZ 654-W3M2	⊕	1NO+1NC	FZ 656-W3M2	⊕	1NO+1NC	FZ 657-W3M2	⊕	1NO+1NC
9	L	FZ 952-W3M2	⊕	2NC	FZ 954-W3M2	⊕	2NC	FZ 956-W3M2	⊕	2NC	FZ 957-W3M2	⊕	2NC
10	L	FZ 1052-W3M2		2NO	FZ 1054-W3M2		2NO	FZ 1056-W3M2		2NO	FZ 1057-W3M2		2NO
20	L	FZ 2052-W3M2	⊕	1NO+2NC	FZ 2054-W3M2	⊕	1NO+2NC	FZ 2056-W3M2	⊕	1NO+2NC	FZ 2057-W3M2	⊕	1NO+2NC
21	L	FZ 2152-W3M2	⊕	3NC	FZ 2154-W3M2	⊕	3NC	FZ 2156-W3M2	⊕	3NC	FZ 2157-W3M2	⊕	3NC
22	L	FZ 2252-W3M2	⊕	2NO+1NC	FZ 2254-W3M2	⊕	2NO+1NC	FZ 2256-W3M2	⊕	2NO+1NC	FZ 2257-W3M2	⊕	2NO+1NC
2	R	FZ 252-W3M2		2NO+2NC	FZ 254-W3M2		2NO+2NC	FZ 256-W3M2		2NO+2NC	FZ 257-W3M2		2NO+2NC
Max. speed		page 239 - type 1			page 239 - type 1			page 239 - type 1			page 239 - type 1		
Min. force		0.07 Nm (0.25 Nm ⊕)			0.07 Nm (0.25 Nm ⊕)			0.07 Nm (0.25 Nm ⊕)			0.07 Nm (0.25 Nm ⊕)		
Travel diagrams		page 241 - group 4			page 241 - group 4			page 241 - group 4			page 241 - group 4		

All measures in the drawings are in mm

Increased actuating force

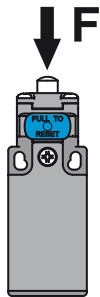

The switch can be delivered with increased actuating force (option W4). Ideal for applications with vibrations.

Actuators	Min. force
01, 14, 15, 16	7 N
02, 05	6 N
07	3.5 N
30 ... 57	0.08 Nm